

# Novara PIR



## SPECIFICATION:

220 -240V/AC, 50/60Hz

15W (1300LM), 4000K

IP65

Working Temperature: -20~+40°C

Detection Range: 140° , max.9m(<24°C), Detection Motion Speed: 0.6-1.5m/s

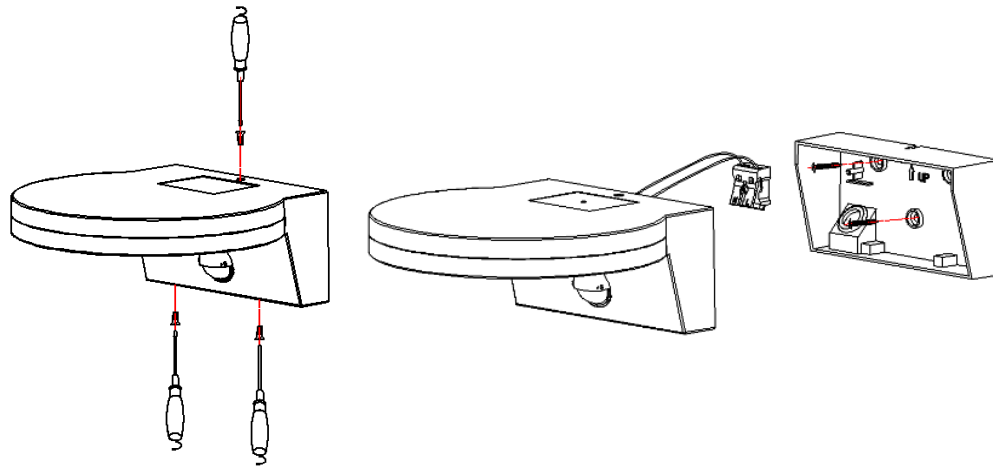
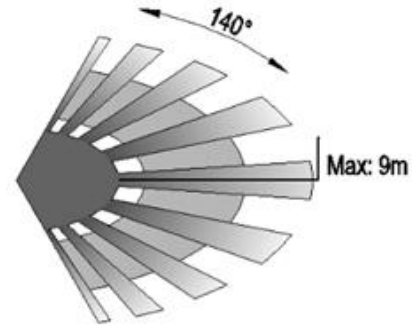

Installing Height: 1.8-2.5m

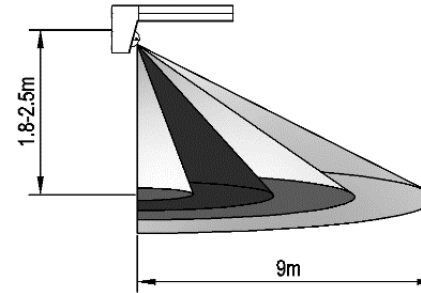

Ambient Light: <3-2000LUX(adjustable), time: Min.10sec±3sec, Max.5min±1min

