

CZ - RAINBOW H RC - Návod k obsluze

Před zahájením instalace si pečlivě přečtete následující informace.
Před instalací či jakoukoliv manipulací po instalaci vypněte přívod elektrického proudu!

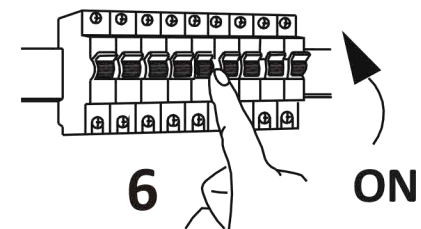
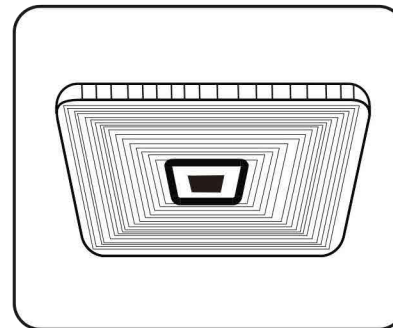
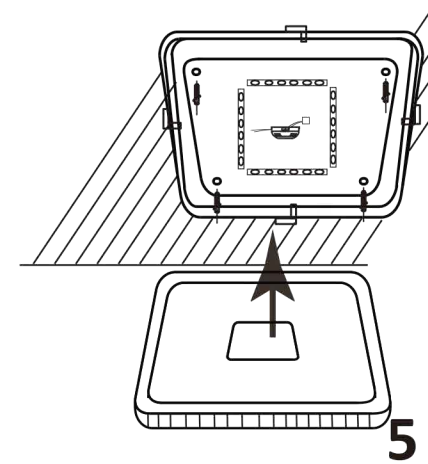
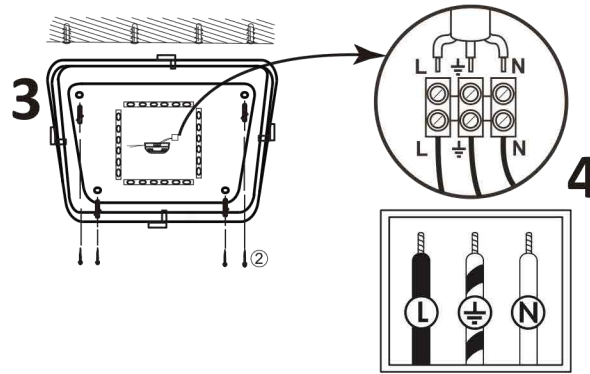
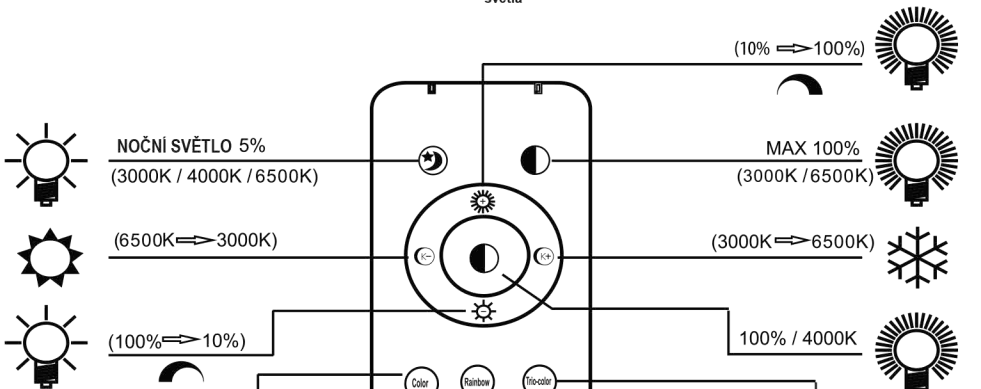
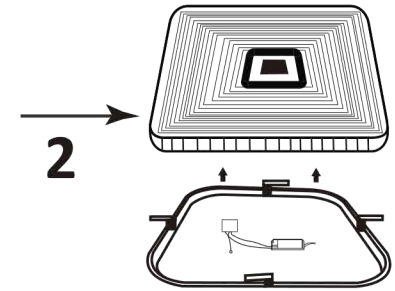
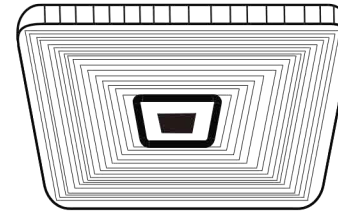
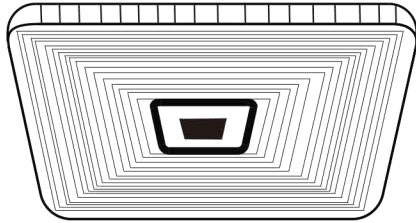
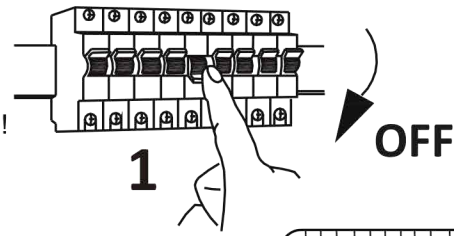

STEP 1 Color Red	STEP 2 Color Orange	STEP 3 Color Yellow	STEP 4 Color Green
STEP 5 Color Cyan	STEP 6 Color Blue	STEP 7 Color Purple	STEP 8 Color Rainbow

STEP 1 Trio-color Trio-color diagonal-1	STEP 2 Trio-color Trio-color diagonal-2
STEP 1 Rainbow Rainbow Rotating	STEP 2 Rainbow Rainbow Static

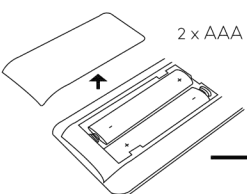

SK - RAINBOW H RC - Návod k obsluhu

Pred zahájením inštalácie si pozorne prečítajte nasledujúce informácie.
Pred inštaláciou či akoukoľvek manipuláciou po inštalácii vypnite prívod elektrického prúdu!

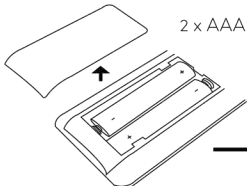
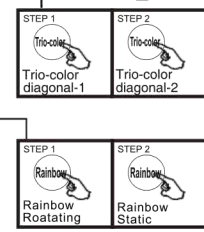
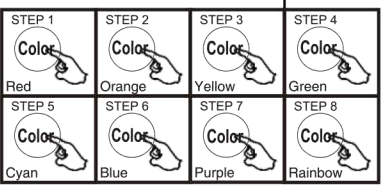
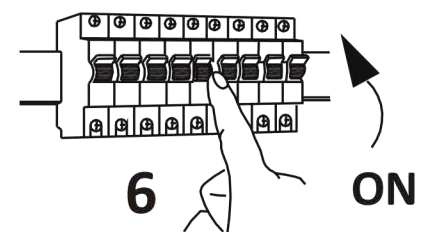
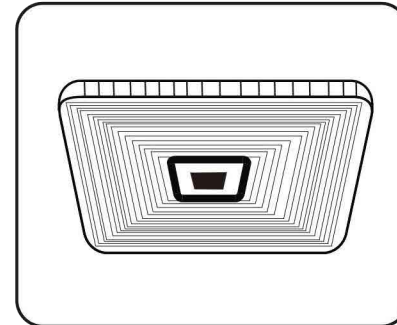
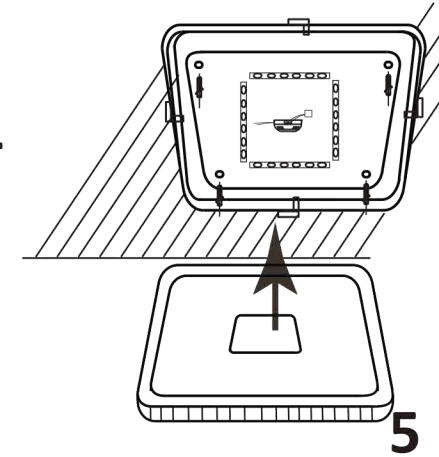
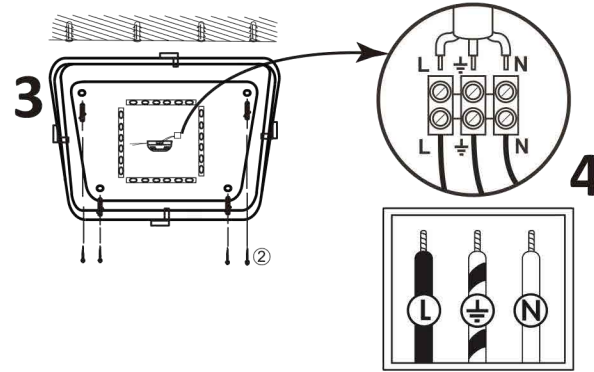
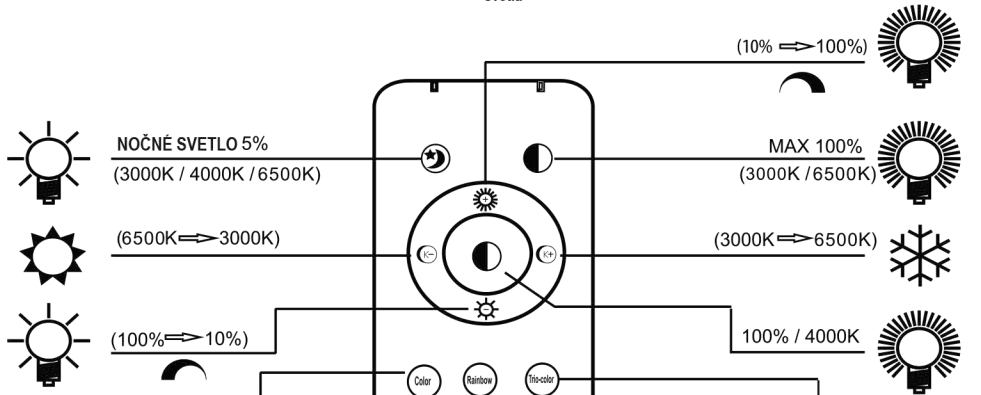
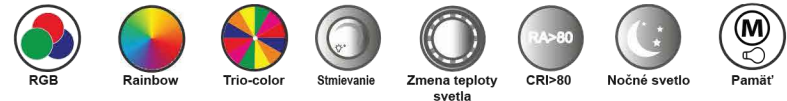
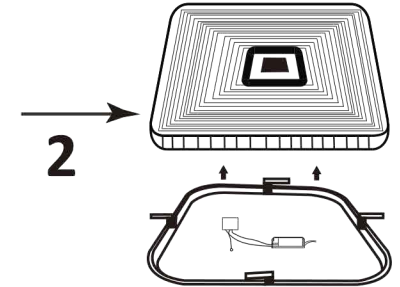
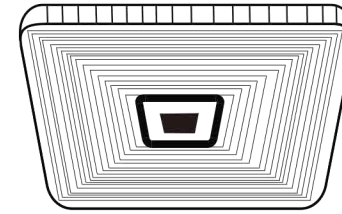
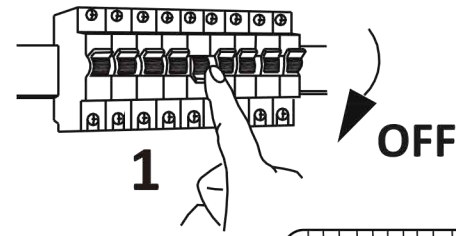
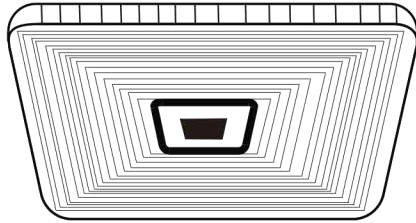

RO - RAINBOW H RC - Instrucțiuni de utilizare

Înainte de instalare citiți cu atenție următoarele informații.
Înainte de instalare sau la orice manipulare după instalare întrerupeți alimentarea cu curent electric!

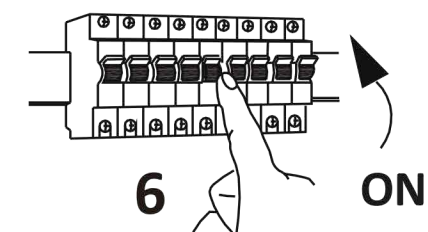
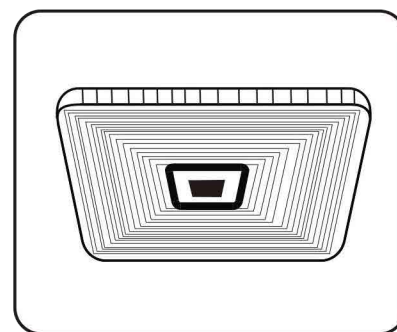
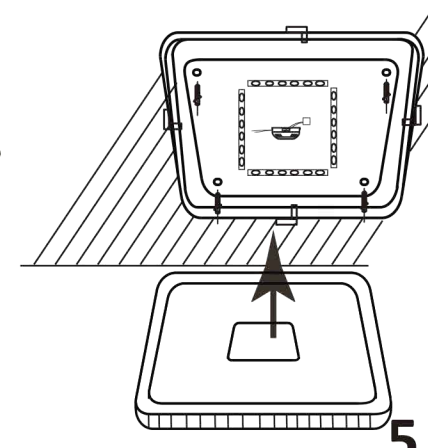
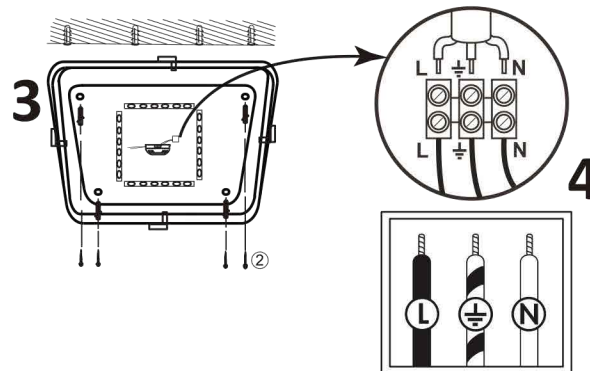
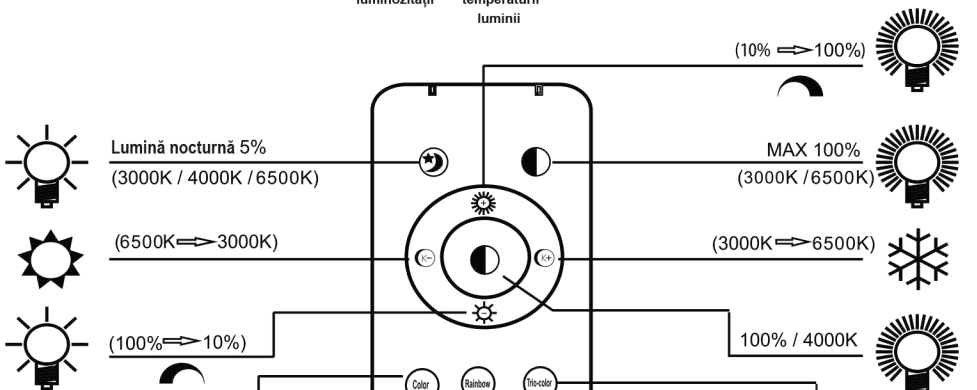
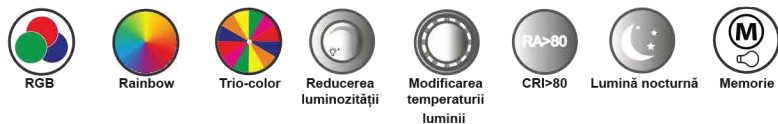
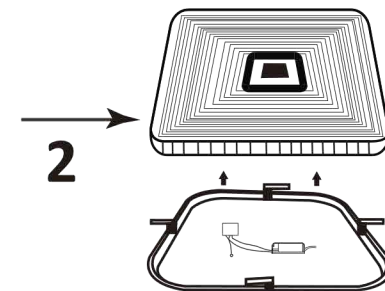
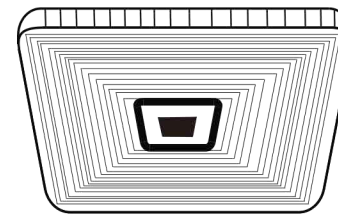
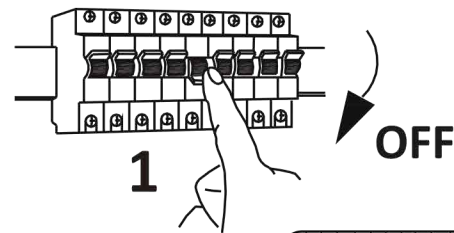
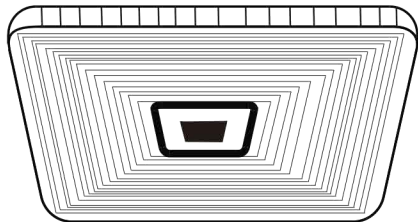

STEP 1 Color Red	STEP 2 Color Orange	STEP 3 Color Yellow	STEP 4 Color Green
STEP 5 Color Cyan	STEP 6 Color Blue	STEP 7 Color Purple	STEP 8 Color Rainbow

STEP 1 Trio-color Trio-color diagonal-1	STEP 2 Trio-color Trio-color diagonal-2
STEP 1 Rainbow Rainbow Rotating	STEP 2 Rainbow Rainbow Static

