

Hisense

Quick Start Guide

PARTY SPEAKER
Model: Party Rocker One
Model: Party Rocker One Plus

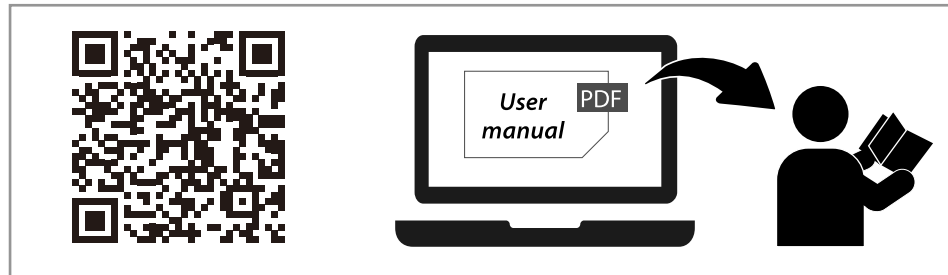
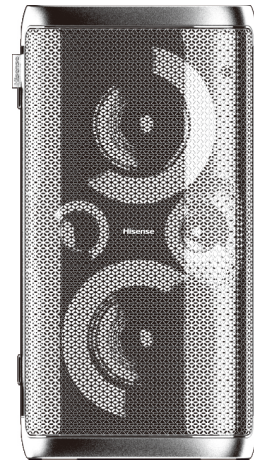

What's in the Box

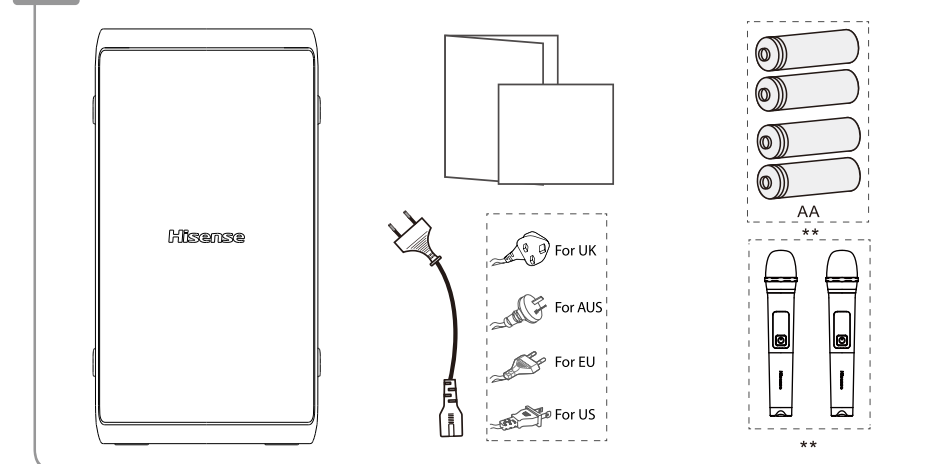

- EN** *Power cord quantity and plug type vary by regions. ** Only for Party Rocker One Plus. For other source connections /detailed operation, please refer to Complete UM on web.
- FR** *Le nombre de cordons d'alimentation fournis et le type de prise varient selon les régions.** Uniquement pour le Party Rocker One Plus. Pour d'autres connexions de sources ou le fonctionnement détaillé, veuillez vous référer au manuel de l'utilisateur sur le Web.
- DE** *Netzkaabel und Steckertyp variieren je nach Region.** nur für Party Rocker One Plus. Für andere Anschlüsse von Quellen und eine detaillierte Beschreibung der Bedienung lesen Sie bitte die vollständige Bedienungsanleitung im Internet.
- IT** *La lunghezza del cavo di alimentazione ed il tipo di spina variano in base alla regione.** Solo per il Party Rocker One Plus. Per la connessione di altre sorgenti/dettagli sull'utilizzo, fare riferimento al manuale completo sul web.
- ES** *La cantidad de cable de alimentación y el tipo de enchufe varían según la región.** Solo para Party Rocker One Plus. Para la conexión de otras fuentes/operación detallada, consulte el MU Completo en la web.
- SL** *Število napajalnih kablov in priključki so odvisni od regije.** Le za Party Rocker One Plus. V popolnem spletnem priručniku za uporabo so navodila za povezave do drugih virov ter podrobnosti o delovanju/uporabi.
- HR** *Količina kabela za napajanje i vrsta utikača razlikuju se po regijama.** samo za model Party Rocker One Plus. Za poveznice na druge izvore / detaljne informacije o radu pogledajte cijeli korisnički priručnik na mreži.
- CZ** *Počet napájecích kabelů a typ zástrčky se liší podle regionu.** jen pro Party Rocker One Plus. Připojení k jiným zdrojům nebo podrobné informace o používání najdete v kompletní uživatelské příručce na webu.
- SK** *Dĺžka napájacieho kábla a typ zástrčky sa líšia v závislosti od regiónu.** Len pre Party Rocker One Plus. Pripojenia k iným zdrojom/podrobné informácie o obsluhu nájdete v Kompletnej používateľskej príručke na webe.
- HU** *Az áramkábel hossza és a dugvilla típusa régióként eltérő.** Csak Party Rocker One Plus esetén. Más forrásokhoz való csatlakozáshoz/részletezett kezeléshez tekintse meg a teljes felhasználói kézikönyvet az Interneten.
- PT** *A quantidade de cabo de alimentação e o tipo de fcha variam de acordo com a região.** Apenas para Party Rocker One Plus. Para outras ligações de entradas/funcionamento detalhado, consulte o MU Completo na Internet.
- RO** *Cantitatea de cabluri de alimentare și tipul de ștecher variază în funcție de regiune.** numai pentru Party Rocker One Plus. Pentru conectarea la alte surse/funcționarea detaliată, vă rugăm să consultați manualul complet de utilizare disponibil online.
- PL** *Liczba kabli zasilających i wtyczek zależy od regionu.** Tylko dla Party Rocker One Plus. Informacje na temat połączeń z innymi źródłami lub szczegółowej obsługi można znaleźć w pełnej instrukcji obsługi dostępnej w Internecie.
- RU** *Количество шнуров питания и тип вилки зависят от региона.** только для Party Rocker One Plus. Информацию о подключении других источников / подробное описание работы см. В полном руководстве пользователя в Интернете.
- SR** *Broj strujnih kablova i vrste utikača variraju u zavisnosti od regiona.** Samo za Party Rocker One Plus. Za druga povezivanja izvora / detaljni rad, pogledajte kompletno korisničko uputstvo na internetu.
- MK** *Должината на електричниот кабел и типот на приклучок се разликуваат според регионите.** Само за Party Rocker One Plus. За други поврзувања на изворот / детални операции, погледнете го целосното КУ на веб.
- SQ** *Sasia e kordonit elektrik dhe lloji i spinës ndryshojnë sipas rajoneve.** Vetëm për Party Rocker One Plus. Për lidhje të tjera të burimit / funksionim të detajuar, referohuni të "Manuali i plotë i përdoruesit në ueb.
- BS** *Količina napojnog kabla i utikač razlikuju se u zavisnosti od regiona.** Samo za Party Rocker One Plus. Za spajanje drugih izvora / detaljne podatke o radu pogledajte čitav priručnik na mreži.
- GR** *Ο αριθμός των καλωδίων ρεύματος και ο τύπος του φics διαφέρουν ανάλογα με την περιοχή. Για άλλες συνδέσεις πηγής / λεπτομερή λεπτομέρεια, ανατρέξτε στο Πλήρες εγχειρίδιο χρήσης στο διαδίκτυο.
- BG** *Количеството захранващи кабели и типът на щепсела са различни в различните региони. За други връзки на източника / подробни указания за експлоатация, моля, направете справка с Пълното ръководство на потребителя в интернет.
- KAZ** *Қуат сымның саны мен аша түрі аймақтарға байланысты ерекшеленеді. Басқа бастапқы қосылымдарды / толық пайдалану жағдайларын интернеттегі UM толық нұсқасынан қараңыз.

تختلف كمية سلك الطاقة ونوع القابس حسب المنطقة. ** فقط ل Party Rocker One Plus

AR

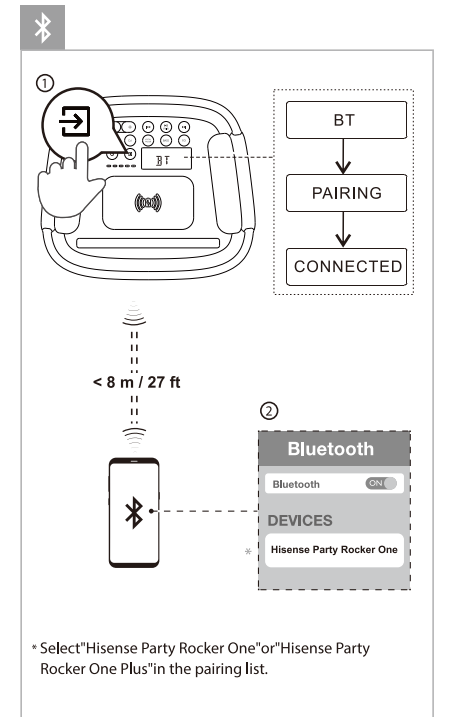
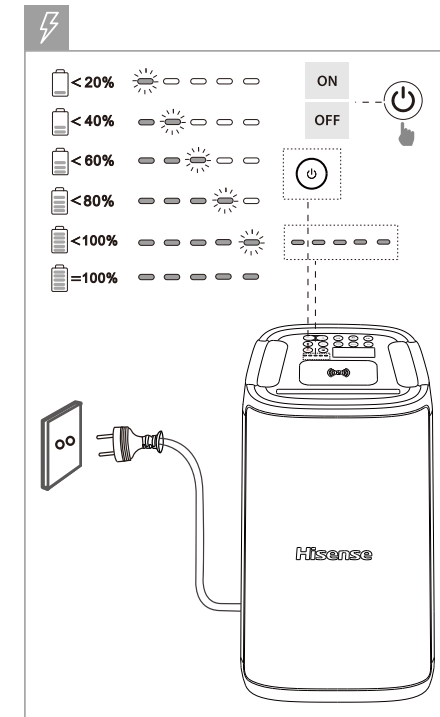

* Select "Hisense Party Rocker One" or "Hisense Party Rocker One Plus" in the pairing list.

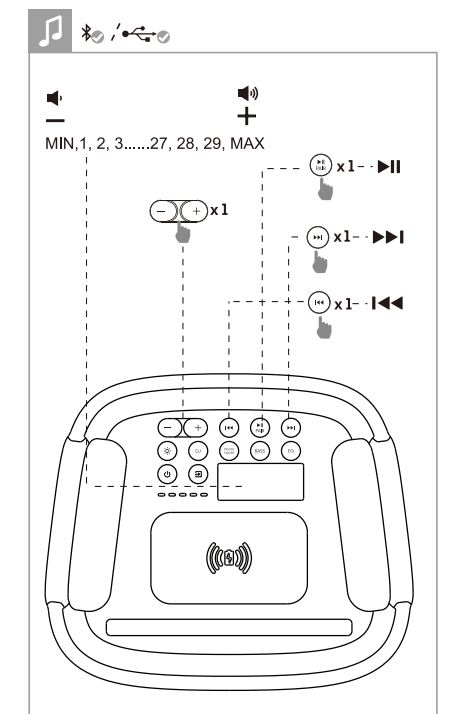
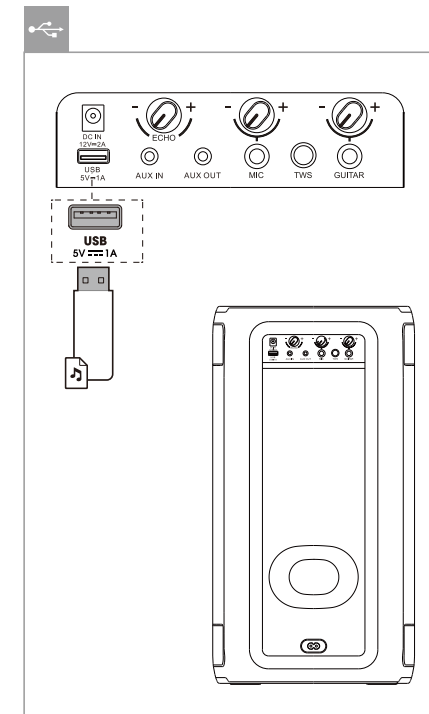

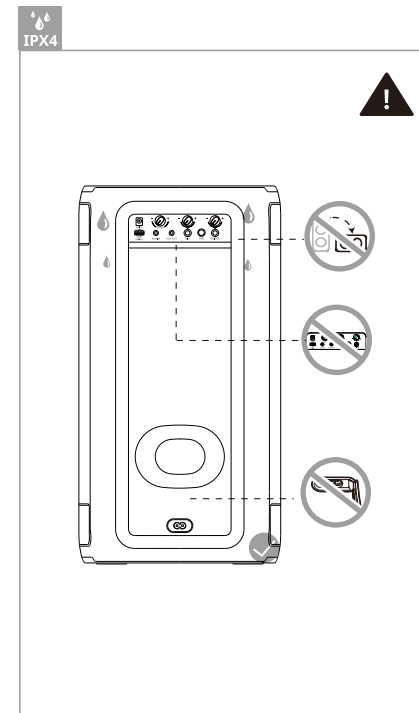
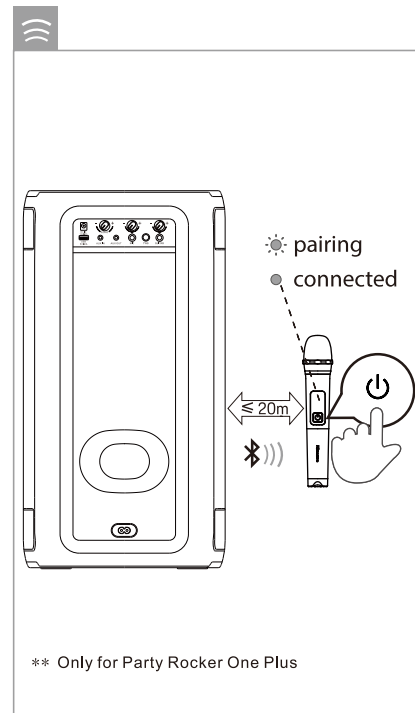
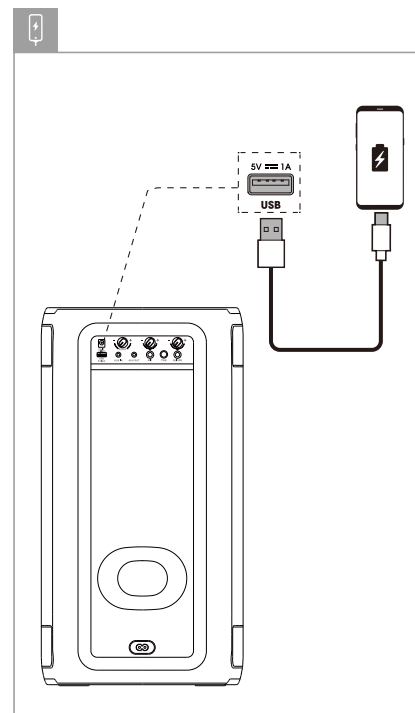
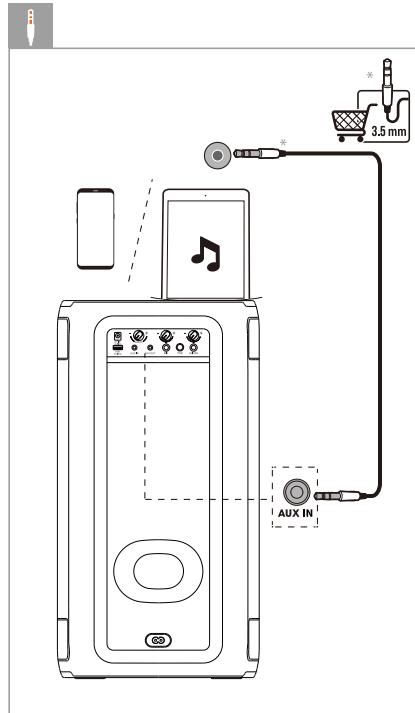
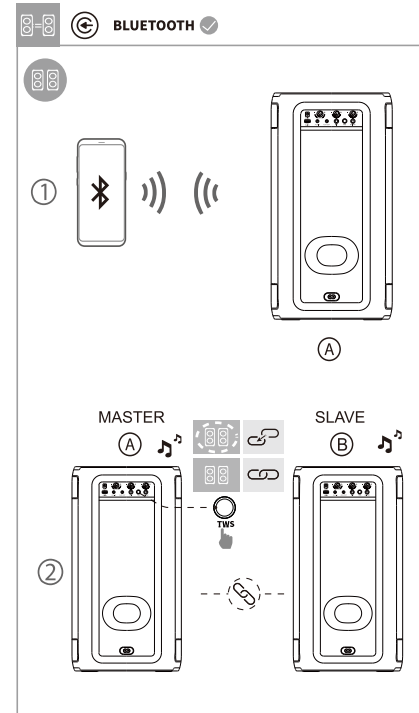
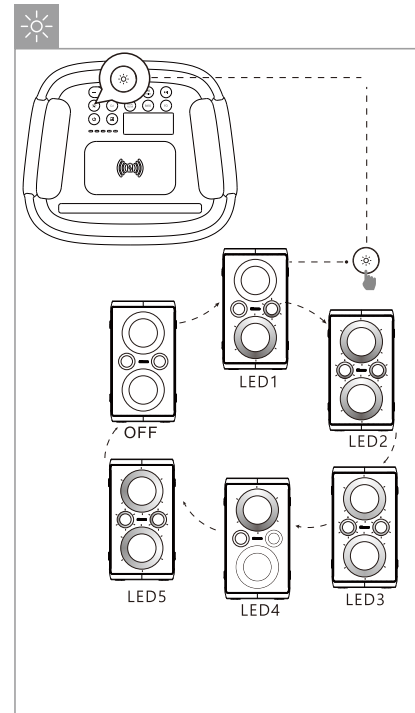
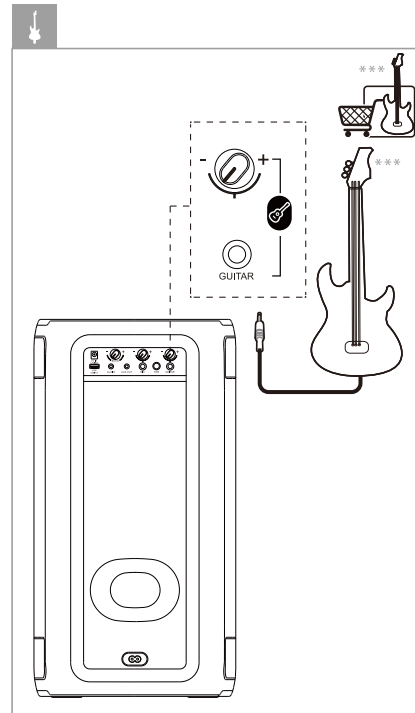
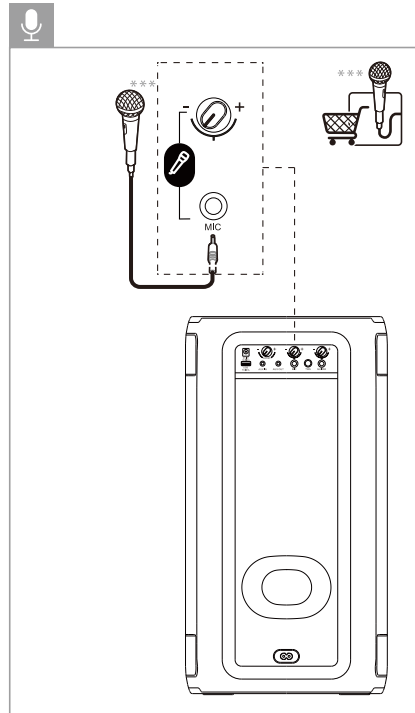

** Only for Party Rocker One Plus

TRADEMARK



The Bluetooth® word mark and logos are registered trademarks owned by Bluetooth SIG, Inc. We are the licensee to use such marks. Other trademarks and trade names are those of their respective owners.

Hisense

EU Declaration of conformity (DoC)

Unique identification of this DoC: H-GJYX-20200925-005

We, Declare under our sole responsibility that the product:
 Product Name: Audio Equipment
 Trade Name: Hisense
 Model: Party Rocker One, Party Rocker One Plus

To which this declaration relates is in conformity with the essential requirements and other relevant requirements of the radio equipment directive (2014/53/EU), Eco design Directive (2009/125/EC) & Regulation 1275/2009/EC, RoHS Directive (2011/65/EU and its amendment (EU) No. 2015/863).

The product is in conformity with the following standards and /or other normative documents:

Health & Safety (Art. 3(1)(a)): EN62479:2010, EN 50663:2017, EN IEC 62311: 2020, EN 50665:2017, IEC 62368-1:2014, EN 62368-1:2014+A11:2017

EMC (Art. 3(1)(b)): EN 55032: 2015/A1:2020, EN 55035:2017/A11:2020

EN IEC 61000-3-2:2019, EN 61000-3-3:2013/A1:2019

ETSI EN 301 489-1 V2.2.3: 2019, ETSI EN 301 489-3 V2.1.1: 2019, ETSI EN 301 489-17 V3.2.4: 2020

Spectrum (Art. 3(2)): ETSI EN 300 328 V2.2.2: 2019, ETSI EN 303 345-1 V1.1.1: 2019, ETSI EN 303 345-3 V1.1.1: 2021, ETSI EN 303 417 V1.1.1: 2017

ErP: COMMISSION REGULATION (EC) No 1275/2008, (EU) No 801/2013, IEC 62087-1:2015, IEC 62087-6:2015, EN 50564: 2011, IEC62301:2011

RoHS: 2011/65/EU and its amendment (EU) No. 2015/863

Place and date of issue (of this DoC): Qingdao, Shandong, China; 2022-5-27

Signed by or for the manufacturer: Hisense International Co., Ltd

Address: Hisense Tower, 17 Donghai Xi Road, Qingdao, Shandong, China

Title: Product Manager

Name (in print): Make Yan *Shaoqun Yan*

Signature: _____

